

*** BILL OF MATERIAL ***

PT NO.	QTY	DESCRIPTION
1	1	CASE, TOOL PATRIOT LITHIUM-ION
2	1	BATTERY, LITHIUM ION 18V
3	1	CHARGER, BATTERY LITHIUM ION
4	1	BATTERY CHARGER SAFETY OPERATING MAINTENANCE & INSTRUCTIONS
5	1	LANYARD
6	1	SOMI, PATCOUT245LI
7	1	FIVE YEAR WARRANTY CARD
8	1	MSDS, LITHIUM-ION BATTERY

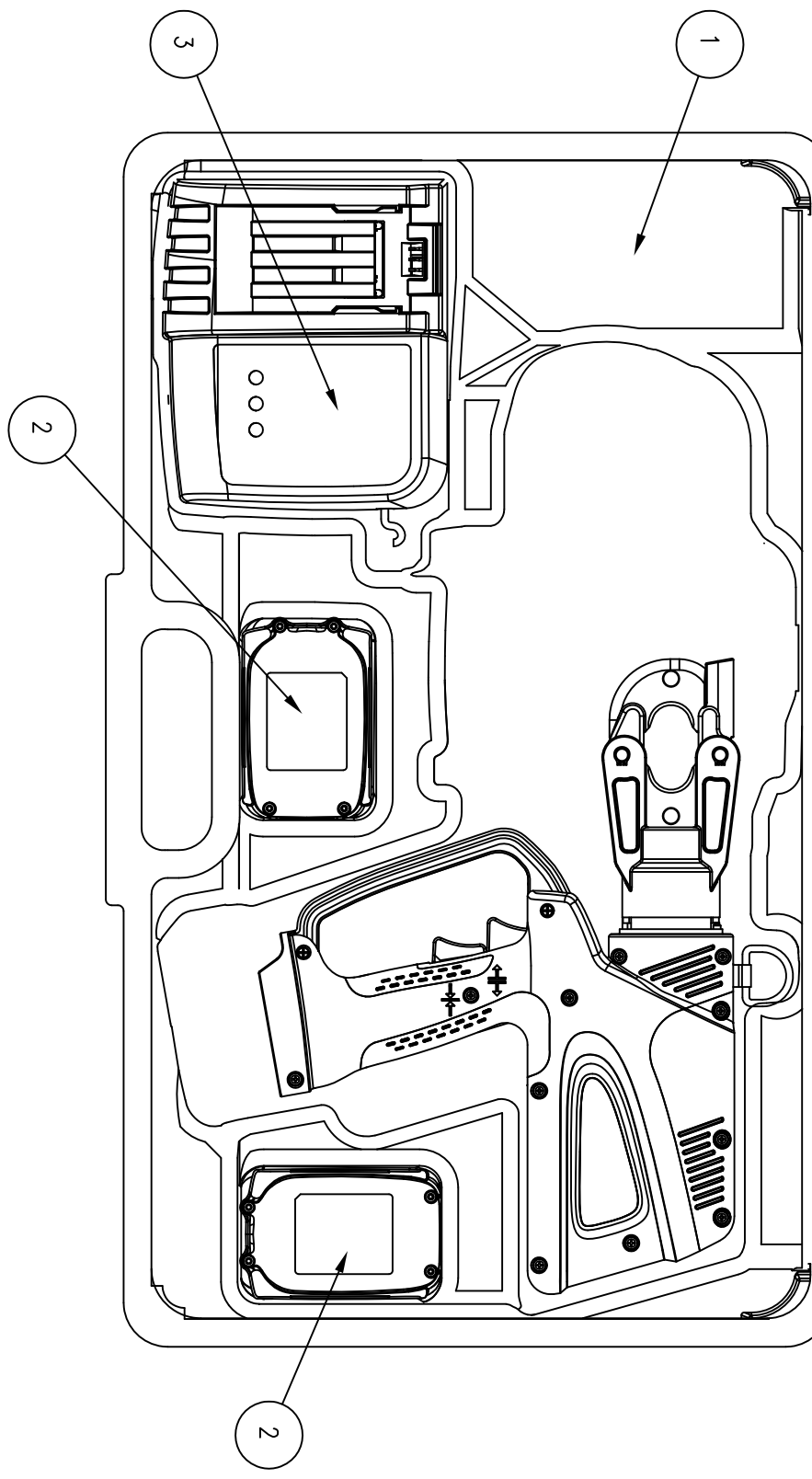
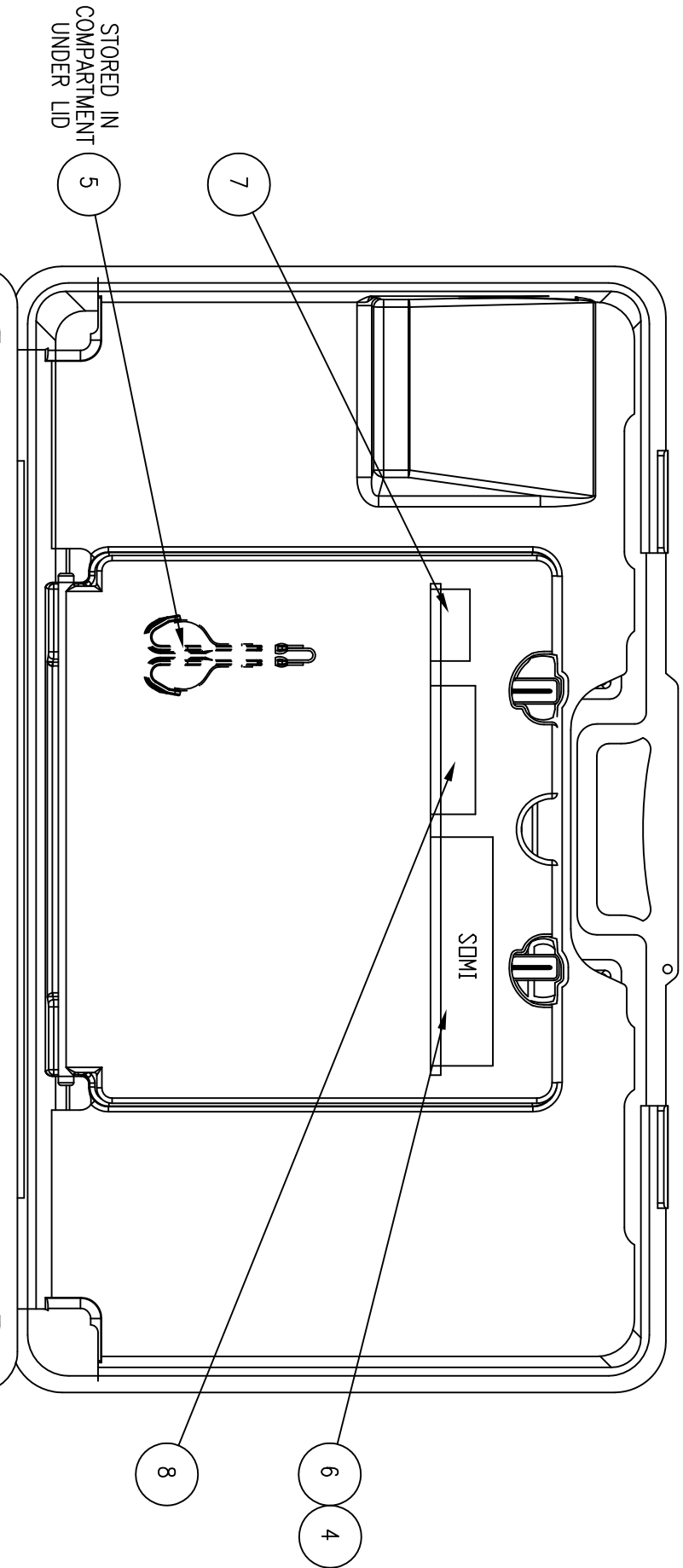

STORED IN COMPARTMENT UNDER LID

- TECHNICAL NOTES:
- SPECIFICATIONS:
 OUTPUT FORCE: 6 TONS (5.4 METRIC TONS)
 TOOL WEIGHT WITH BATTERY: 10.1 LBS (4.5 kg)
 LENGTH: 14.5 IN (36.8 cm)
 WIDTH: 3.5 IN (8.9 cm)
 HEIGHT: 13.7 IN (34.9 cm)
 OPERATING VOLTAGE: 18V-DC
 RECHARGE TIME: 30 MINUTES
 - FOR USE ON:
 COPPER: #8 - 600 kcmil TERMINALS: YA, YA-L
 COPPER FLEX: #8 - 350 kcmil SPLICES: YS, YS-L, YS-T, YS-R
 ALUMINUM: #8 - 350 kcmil TERMINALS: YA-FX, YAY, YA-L-FX
 SPLICES: YS, YSY-FXB
 TERMINALS: YA-A, YA-A-TN
 SPLICES: YS-A
 - USES "W" DIE SETS
 - SPECIFICATIONS SUBJECT TO CHANGE WITHOUT NOTICE.

- FEATURES AND BENEFITS
- FIELD PROVEN ELECTRONICS FOR ULTIMATE RELIABILITY IN THE HARSHTEST ENVIRONMENTS.
 - OVERMOLDED HANDLE FOR COMFORT AND IMPROVED GRIP; ALLOWS FOR ONE HANDED OPERATION FOR ADVANCE RETRACT AND HOLD.
 - 18 VOLT LITHIUM-ION BATTERIES PROVIDE 2.5 TIMES MORE CHARGE/DISCHARGE CYCLES THAN TRADITIONAL Ni-Cd BATTERIES AND PROVIDE 430% MORE LIFETIME WORK.
 - 30 MINUTE CHARGER CONTROLS CURRENT, VOLTAGE AND TEMPERATURE TO MAXIMIZE BATTERY LIFE.
 - FORCED AIR COOLING FAN COOLS THE BATTERY BY FORCING COOL AIR THROUGH THE BATTERY'S BUILT IN AIR VENTS.
 - SPECIALIZED LATCH HEAD DESIGN ALLOWS INTERFERENCE FREE CLOSURE ON TAP CONNECTORS.
 - PERMANENT "J3" CRIMP GROOVE ACCEPTS "W", "X" AND "W-VI" DIES.
 - PAT600C-LI WITH COVERED HEAD IS AVAILABLE.
 - STATE OF THE ART CRIMPING HEAD DESIGN, 180° HEAD ROTATION LETS USER GET INTO TIGHT AREAS EASIER.
 - ERGONOMICALLY BALANCED TOOL DESIGN EASES OPERATION AND HELPS LESSEN FATIGUE.
 - DURABLE HIGH IMPACT FORMED CARRYING CASE PROVIDES SUPERIOR PROTECTION AND STORES ALL ACCESSORIES.

REV.	ECN	DATE	DESCRIPTION	CHG BY	APPD BY
1	17987	8/13/12	INITIAL RELEASE	CG	

Created on AUTOCAD

DIMENSIONING AND TOLERANCE PER ANSI Y14.5M-1982 UNLESS OTHERWISE SPECIFIED, DIMENSIONS ARE IN INCHES (MM). TOLERANCES
 .XX = ±.01 (.25)
 .XXX = ±.005 (.127)
 .XXXX = ±.0025 (.0635)
 ANGLE TOL ±1°

PROJECT REFERENCE: 2011-041

MATERIAL: SEE NOTES

DRAWN BY: C. GRIBBLE 8/13/12

CHECKED BY:

APPROVED BY:

HUBBELL
 Hubbell Premise Wiring
 HUBBELL INCORPORATED (Delaware)
 23 CLARA DRIVE, SUITE 103 MVSSTC, CT 06355

TITLE: COMPRESSION TOOL, 6 TONS, W DIE COMPATIBLE

SIZE: C DRAWING NO. HWS14122C REV. 1

SCALE: 1/1 SHEET 1 OF 1